

# Z8508NEQ / Z8516NEQ

## 8/16-Channel H.265 Network Video Recorder



- H.265/H.264 decoding
- Support 8- or 16-channel 5MP IP cameras input & preview
- Support 4-channel real-time playback synchronously
- HDMI output up to 1080P high definition
- Intelligent video analytics functions
- TCP/IP, DHCP, DDNS, SMTP, NTP, UPNP, RTSP, etc.
- P2P cloud service supported
- ONVIF Profile S compatible



### System Overview

NVR of the Z8000NEQ series 8/16CH models could deliver up to 5MP resolution excellent image over advanced H.265 decoding. It's an ideal consideration for the balance of quality, performance, and budget.

The user-friendly GUI provides intuitive shortcut operations, remote control, management, flexible storage, and playback. Powered by the reliable interoperability and ONVIF Profile S, it's compatible with plenty of 3rd-party IPC or crossing platform VMS. The devices can be used in governmental institutions, bank sectors, manufacturers, educational or commercial projects.

### Functions

IVA functions supported (Intelligent Video Analytics) such as Tripwire / Target Counting / Object Left/Lost / Intrusion , etc.

User-friendly & full function VMS / Mobile App

Alarm events linkage actions such as email, audio, buzzer and alarm push message to Mobile App and VMS

### Technical Parameters

Model	Z8508NEQ	Z8516NEQ
System		
Main Processor	Multi-core embedded processor	
Operating System	Embedded LINUX	

## Z8508NEQ / Z8516NEQ

Video and Audio		
Max IPC Input	8CH	16CH
Two-way Talk	Support	
Audio Compression	G.711u	
Live View		
Display Split	1/4/6/8 CH	1/4/6/9/16 CH
Resolution	5MP(2592*1944) / 2MP(1920*1080) / 1.3MP(1280*1024) / 1MP(1280*720) / D1(1024*768)	
Live View Capability	1CH@5MP / 8CH@D1(25/30fps)	1CH@5MP / 16CH@D1(25/30fps)
Recording		
Video Compression	H.265 / H.264	
Recording Resolution	5MP/3MP/1080P/960P/720P/D1/VGA/4CIF/DCIF/2CIF/CIF/QCIF	
Max. Decoding Capability	8CH@5MP (25/30fps)	16CH@5MP (25/30fps)
Incoming Bandwidth	60 Mbps	80 Mbps
Bit Rate	Main Stream: 16Kbps ~ 8192Kbps	
	Sub Stream: 50Kbps ~ 700Kbps	
Record Mode	Schedule, Manual, Motion Detection, IVA Events Alarm	
Record Interval	1 ~ 120 min (default: 60 min), Pre-record: 1 ~ 30 sec, Post-record: 10 ~ 300 sec	
Playback and Backup		
Playback Channel	4CH synchronously playback	
Search Mode	Time/ Date, Alarm Types, IVA Search	
Playback Function	Play, Stop, Play Forward, Play Backward, 30 Seconds Forward, 30 Seconds Backward, Fast Play, Slow Play, Single Frame Play, Hide/Show Time Bar, Backup, Snapshot, Full Screen	
Backup Mode	USB Device / Network Remote	
IVA Alarm		
Local IVA Functions	Tripwire / Target Counting / Counting Statistics/Object Left/Lost / Intrusion	
Regular Detection	Motion Detection / Video Shelter / Video Loss	
AI Search	Support search target video by multiple intelligent conditions	
Network		
Network Protocol	TCP/IP, UDP, HTTP, DDNS, SMTP(SSL), DHCP, RTSP, NTP, P2P	
Max. Online User	20	
Web Browser	Internet Explorer/Microsoft Edge	
ANR (Automatic Network Replenishment)	Support	
Operation System	Windows	
Management Platform	AntarVis 2.0	
Mobile Application	AntarView Pro (iOS & Android)	
P2P Cloud Service	Support	
Interoperability	ONVIF Profile S, SDK, CGI, API	

## Storage & Auxiliary Interface

SATA Ports	1 SATA Port, up to 12 TB capacity
eSATA	N/A
Raid 0/1/5/6/10	N/A
HDMI	1*HDMI (1080P)
VGA	1920*1080/60Hz, 1280*1024/60Hz
Network Interface	1 RJ-45 Port (10/100Mbps)
PoE Ports	N/A
USB	3*USB 2.0
Audio Input/Output	0/1 output
Alarm Input/Output	N/A
RS-485	N/A

## Power

Power Supply	DC 12V/2A
Power Consumption	24W (without HDD)

## General

Casing	1U
Working Temperature	-10°C ~ 55°C / 14°F ~ 131°F
Working Humidity	0% ~ 90%
Dimensions (L*W*H)	255 * 210 * 43 (mm)
Net Weight	2.5kg (without HDD)
Gross Weight	3kg (without HDD)

## Order Information

Name	Model	Description
NVR	Z8508NEQ	8CH H.265 NVR, 1SATA
	Z8516NEQ	16CH H.265 NVR, 1SATA

## Dimensions (mm)

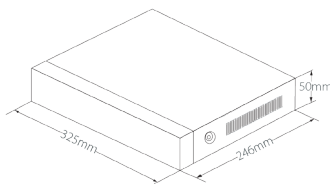

## Rear Panel

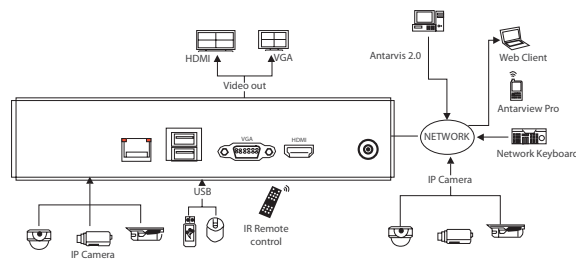

1600 Union Hill Road Alpharetta, GA 30005  
 Phone: (862) 505-2101 | Fax: (862) 204-5906 | info@zktcoua.com | www.zktcoua.com